

\$2,250,000 - 12 Chauncey Circle, Ardsley

MLS® #H4909941

\$2,250,000

5 Bedroom, 5.00 Bathroom, 4,500 sqft
Residential on 1.16 Acres

Chauncey Estates, Ardsley, NY

Welcome to CHAUNCEY ESTATES! Stunning new construction in Ardsley offering state of the art infrastructure & style! An idyllic NEWLY built cul-de-sac of 4 homes & over 5.5 acres of forever-green space. This is the 3rd of these exceptional homes, to be built, by renowned Greenwich Builders with and opportunity to customize. This distinctive 5 BR, 4.5 bath, Colonial sits on a 1.16 park-like acre in The Ardsley School District. Top quality construction and craftsmanship. Home has a wonderful open layout offering great space, light, generously proportioned rooms and 9 Ft ceilings on the 1st floor. Square footage does not include 1,800 Sq Ft in basement. Close to schools and shops. Desirable Greenburgh Rec and Hartsdale Train parking. TIME TO CUSTOMIZE AND BUILD YOUR DREAM HOME!

Built in 2022

Essential Information

MLS® #	H4909941
Price	\$2,250,000
Bedrooms	5
Bathrooms	5.00
Full Baths	4
Half Baths	1
Square Footage	4,500
Square Footage	50530.00

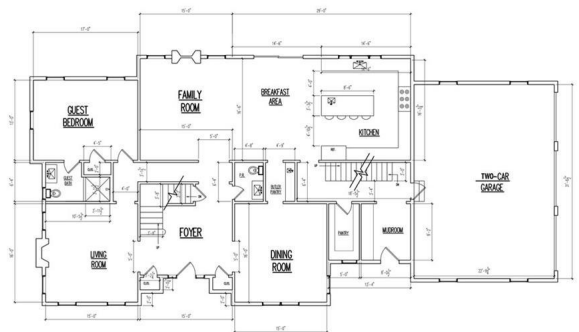

PROPOSED FIRST FLOOR PLAN
1/4" = 1'-0"

12 Chauncey Circle, Ardsley, NY

OneKey MLS

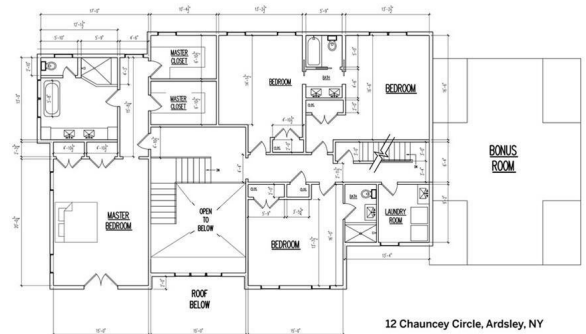

PROPOSED SECOND FLOOR PLAN
1/4" = 1'-0"

12 Chauncey Circle, Ardsley, NY

OneKey MLS

Acres	1.16
Year Built	2022
Type	Residential
Sub-Type	Single Family Residence
Style	Colonial
Status	Active

Community Information

Address	12 Chauncey Circle
Subdivision	Chauncey Estates
City	Ardsley
County	Westchester
State	NY
Zip Code	10502

Amenities

Features	Wooded
Parking	Attached, 2 Car Attached
# of Garages	2
Garages	Attached, 2 Car Attached
View	Panoramic

Interior

Interior Features	Eat-in Kitchen, Formal Dining Room, Entrance Foyer, Granite Counters, Master Bath, Pantry, Powder Room, Walk-In Closet(s)
Appliances	Dishwasher, Dryer, Oven, Refrigerator, Washer, Wine Cooler
Heating	Natural Gas, Hydro Air
Cooling	Central Air
Fireplace	Yes
# of Fireplaces	1
Has Basement	Yes
Basement	Full, Unfinished

Exterior

Exterior	Other, HardiPlank Type
Lot Description	Wooded
Construction	Other, HardiPlank Type

School Information

District	Ardsley
Elementary	Concord Road Elementary School
Middle	Ardsley Middle School
High	Ardsley High School

Additional Information

Date Listed	March 21st, 2019
Days on Market	1151
Taxes	\$100
HOA Fees	0.00

Listing Details

Listing Office Julia B Fee Sothebys Int. Rlty

Information Copyright 2021, OneKey® MLS. All Rights Reserved.

The source of the displayed data is either the property owner or public record provided by non-governmental third parties. It is believed to be reliable but not guaranteed. This information is provided exclusively for consumers'™ personal, non-commercial use.

The data relating to real estate for sale on this website comes in part from the IDX Program of OneKey® MLS.

Listing information last updated on May 16th, 2022 at 12:36am EDT